

# Snappi Chassis All Models Parts List

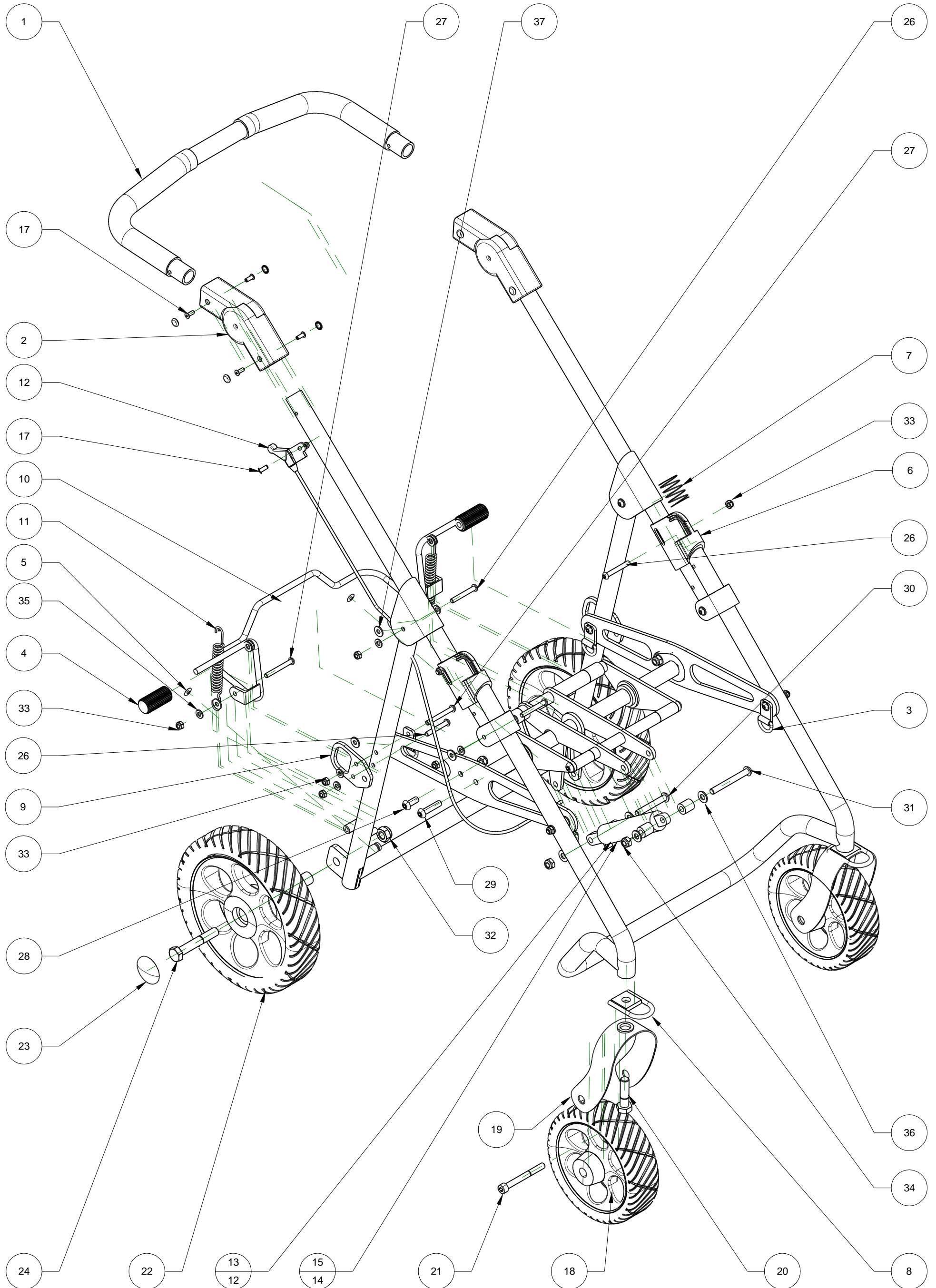

Subject to technical alterations

# Snappi Chassis All Models Parts List



Item Number	Part Number	Description	Qty Per Chassis
1	SN6225 / SN6228	Handle Grip Size 1 / Handle Grip Size 2	2
2	TS6229 / B28090	Push Handle Adjustor (Complete) / Push Button for Push Handle Adjustor	2
3	SN5340 / SN5341	P Clip and D ring	4
4	SN6266	Brake Sleeve	2
5	SN415000	Brake: Blanking Plug With 13mm Head	2
6	SN6231	Frame Locking Slider	2
7	SN6233	Locking Slider Spring	2
8	053rkf011.8	Front Transit Tie Down Bracket	2
9	SN7435	Rear Transit Tie Down Bracket	2
10	053rkf013 / 053rkf023	Brake Assembly Size 1 / Brake Assembly Size 2	1
11	SN7431	Brake spring	2
12	SN7300 or SN7300B	SN7300 - Tilt Cable Full, SN7300B - Cable end fittings only.	1
13	SN7402	Slow Release Gas Spring	1
14	TT7401	Gas Strut Release Head	1
15	TT7402	Gas Strut Release Head Lever	1
16	TT7403	Gas Strut M10 Lock Nut	1
17	RVT110004812	Blind Rivet 4.8 x 14mm	16
18	SN6246	Front Castor	2
19	SN6244	Front Castor Housing	2
20	HTBM12X55Z	Front Castor Frame Bolt: M12 x 55 hex head bolt	2
21	SKTMCAO08X75OZ	Front Castor Wheel Bolt: M8 x 75 socket cap screw	2
22	SN6247	Rear Wheel	2
23	SN6248	Rear Wheel Bolt Cap	2
24	HTBM12X90Z	Rear Wheel Bolt: M12 x 90 hex head bolt	2
25	SKTMB06X40Z	Lower Tie Down Fixings: M6 x 40 socket button screw	2
26	SKTMB06X45Z	Frame Fixings: M6 x 45 socket button screw	6
27	SKTMB06X50Z	Frame Fixings: M6 x 50 socket button screw	4
28	SKTMB08X25Z	Angle Lock Fixings: M8 x 25 socket button screw	2
29	SKTMB08X35Z	Mid Frame Fixings: M8 x 35 socket button screw	6
30	A2MB08X055	Lower Gas Strut Bolt: M8 x 55 Hex Bolt Stainless	1
31	A2MB08X070	Upper Gas Strut Bolt: M8 x 70 Hex Bolt Stainless	1
32	NNYMT12	M12 Type T Nylock Nut	2
33	N986M06Z	M6 Nylock Dome Nut	14
34	N986M08Z	M8 Nylock Dome Nut	6
35	WAMC06Z	M6 Form C Steel Washer	16
36	WAMA08Z	M8 Form A Steel Washer	6
37	NNYM06	M6 x1.6 nylon washer	14

Subject to technical alterations